



Construction

Bronze pump casing with suction and delivery connections with the same diameter and on the same axis (in-line).
Stainless steel AISI 316 can.
Brass unions on request.

Materials	NCS3 ..-40, -50	NCS3 ...-70
Pump casing	Bronze	Bronze
Impeller	Composite	Composite
Shaft	Stainless steel	Ceramic
Bearings	Graphite	Ceramic

Applications

Circulation of sanitary hot water.

Operating conditions

Liquid temperature from +5 °C to +65 °C.
Ambient temperature up to 40 °C.
Sound pressure ≤ 43 dB (A).
Minimum suction pressure: 0,05 bar at 50 °C
Maximum permissible working pressure 10 bar.

Motor

2-pole induction motor, 60 Hz.
Three adjustable speeds.
NCS3: single-phase 220 V.
Insulation class H.
Protection IP 44.

Installation

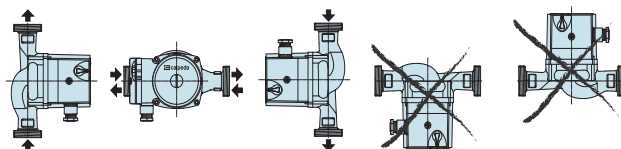

Unions

TYPE	DN	DN1
KIT G 1 1/4 - G 3/4 (NCS3 20..)	G 1 1/4	G 3/4
KIT G 1 1/2 - G 1 (NCS3 25..)	G 1 1/2	G 1

Désignation

NCS3 20 - 40 / 130-60

Série _____
 DN des orifices en mm _____
 Hauteur maxi dm _____
 Entraxe pour installation mm _____
 Frequency 60 Hz _____

Characteristic curves, dimensions and weights

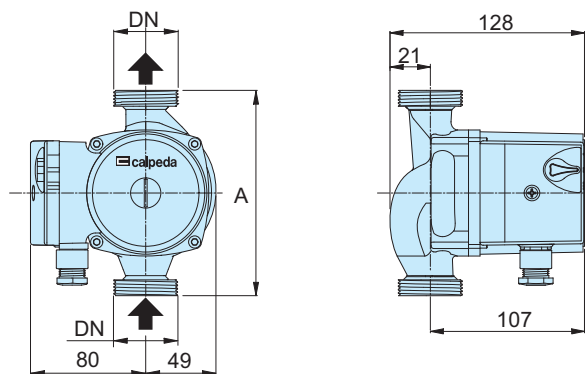
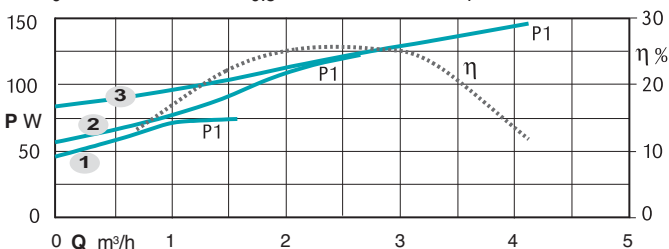
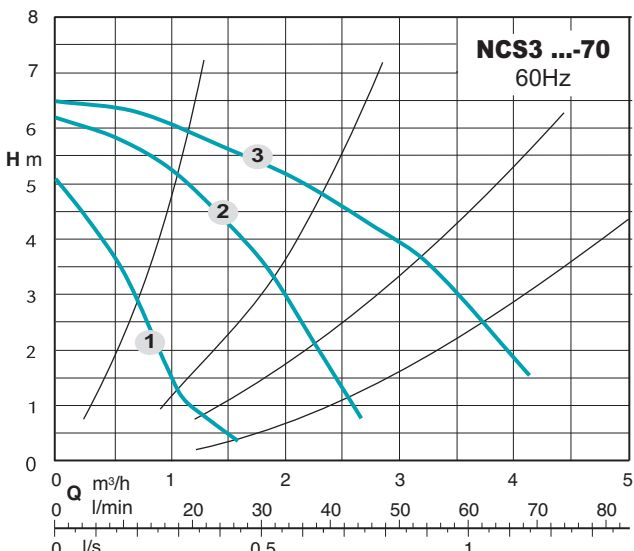
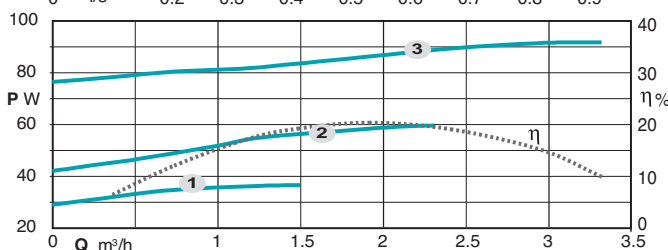
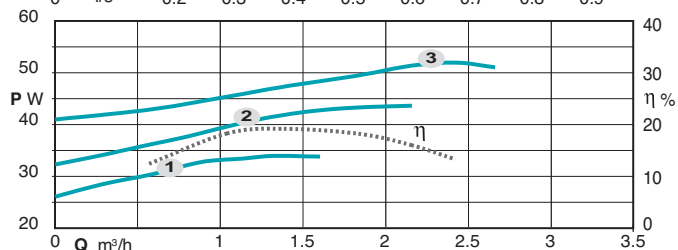
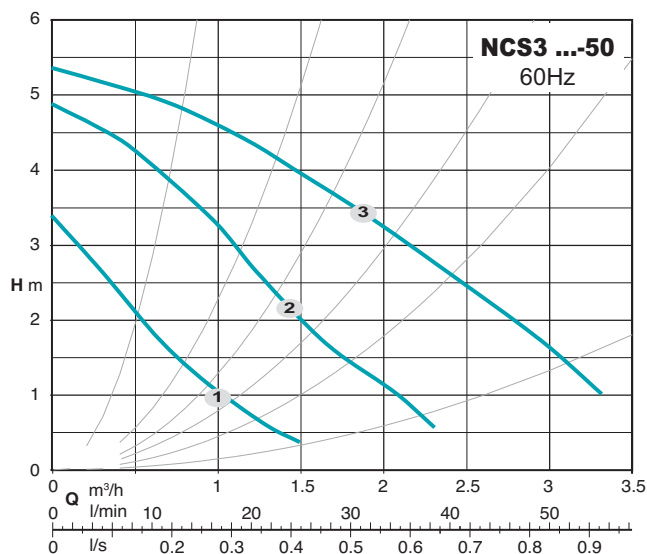
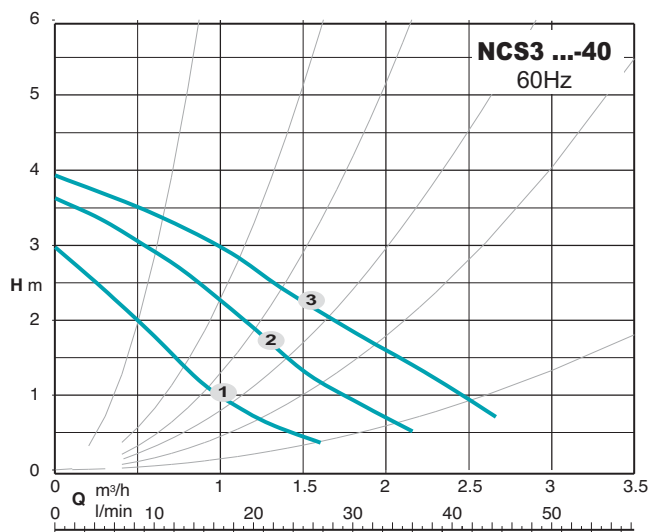

TYPE	DN	Pos.	P1 (W)	1x 230 V [A]	A mm	[kg]
NCS3 20-40/130-60	G 1 1/4	3	53	0,23	130	2,3
NCS3 25-40/130-60	G 1 1/2	2	47	0,21		
NCS3 20-50/130-60	G 1 1/4	3	91	0,38	130	2,5
NCS3 25-50/130-60	G 1 1/2	2	65	0,28		
NCS3 20-70/130-60	G 1 1/4	3	148	0,66	130	3,8
NCS3 25-70/130-60	G 1 1/2	2	128	0,59		
		1	87	0,41		